



Bracket Mate™

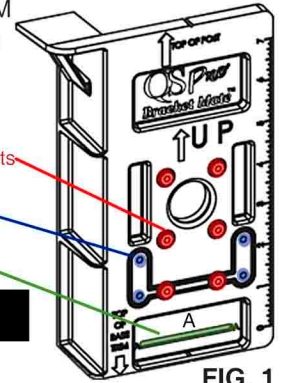

FIG. 1

Tools Required



Marking Pencil



Drill & 1/8" bit

Screw holes for Standard and T-Rail Brackets

Screw holes for Contoured Brackets

Pencil line window "A" for 45 or 22.5 Bracket Adaptors.

Top and Bottom QS Pro Bracket Mounting Instructions

Level Applications Using 32" or 38" Balusters Only.

IMPORTANT: Before beginning your installation, cut post sleeves 40" long for a 36" high rail and 46" long for a 42" high rail. Slide Part # QCAP4PRO QS Pro Low Bases onto posts.

Mounting Bottom Brackets

Place the QS Pro Bracket Mate™ flush with the base trim. Pre-drill 6 **inside** holes. SEE FIG. 1 Attach bottom mounting brackets to post with (6) #10 screws (provided)

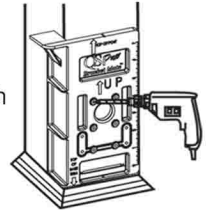

Mounting Top Brackets

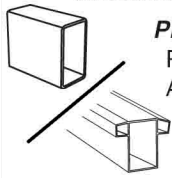

PRO V or PRO Z Standard or T-Rail Top Rail

Place the QS Pro Bracket Mate™ flush with the top of post. Pre-drill 6 **inside** holes. SEE FIG. 1 Attach top mounting brackets to post with (6) #10 screws (provided).



PRO V Contoured Top Rail

Place the QS Pro Bracket Mate™ flush with the top of post. Pre-drill 4 **outside** holes. SEE FIG. 1 Attach top mounting brackets to post with (6) #10 screws (provided)

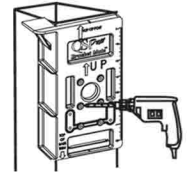

For 22.5 Degree Standard, 45 Degree Standard or 45 Degree Contoured Bracket Adaptor Attachment

Mounting Bottom Brackets

Place the QS Pro Bracket Mate™ flush with the base trim. Mark a pencil line in window "A". SEE FIG. 1 Place bottom edge of bracket adaptor on the line. Using the 4 **inside** holes on the adaptor pre-drill mounting bracket holes. Place bracket mounting plate on top of bracket adaptor and attach to post using (4) #10 screws (provided)

Mounting Top Brackets

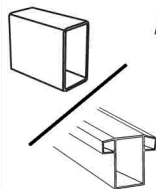

PRO V or PRO Z Standard or T-Rail Top Rail

Measure 30 3/4" for 36" high rail or 36 3/4" for 42" high rail from top of base trim and mark a pencil line on post. Place bottom edge of bracket adaptor on the line. Using the 4 **inside** holes on the adaptor pre-drill bracket mounting holes. Place bracket mounting plate on top of bracket adaptor and attach to post using (4) #10 screws (provided)



PRO V Contoured Top Rail

Measure 32" for 36" high rail or 38" for 42" high rail from top of base trim and mark a pencil line on post. Place bottom edge of bracket adaptor on the line. Using the 4 holes on the adaptor pre-drill bracketing mounting holes. Place bracket mounting plate on top of bracket adaptor and attach to post using (4) #10 screws (provided)

Any questions call the QS Pro team at 1-877-649-9896

HOW TO USE